

Trojan Athena Hinge Adjustment Guide

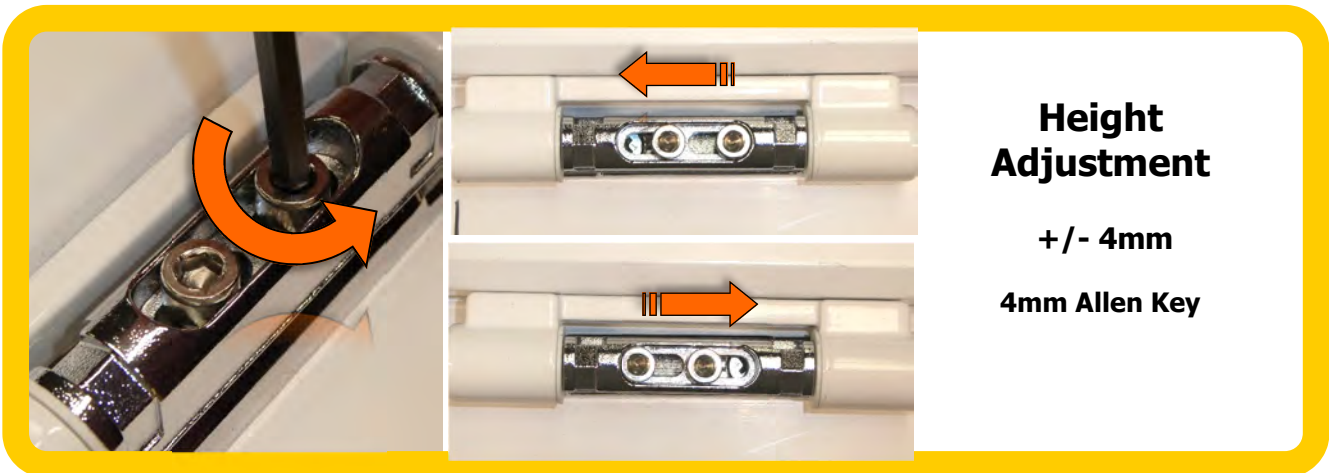

Lateral Adjustment: (Note Lateral and height adjustment can be made simultaneously)
Slacken off both M5 Cap Head Screws **on all hinges** (and ensure they are re tightened after adjustment)
The Door can now be moved one way or the other about the nominal position



Lateral Adjustment: (Note Lateral and height adjustment can be made simultaneously)
Slacken off both M5 Cap Head Screws **on all hinges** (and ensure they are re tightened after adjustment)
The Door can now be moved up or down about the nominal position

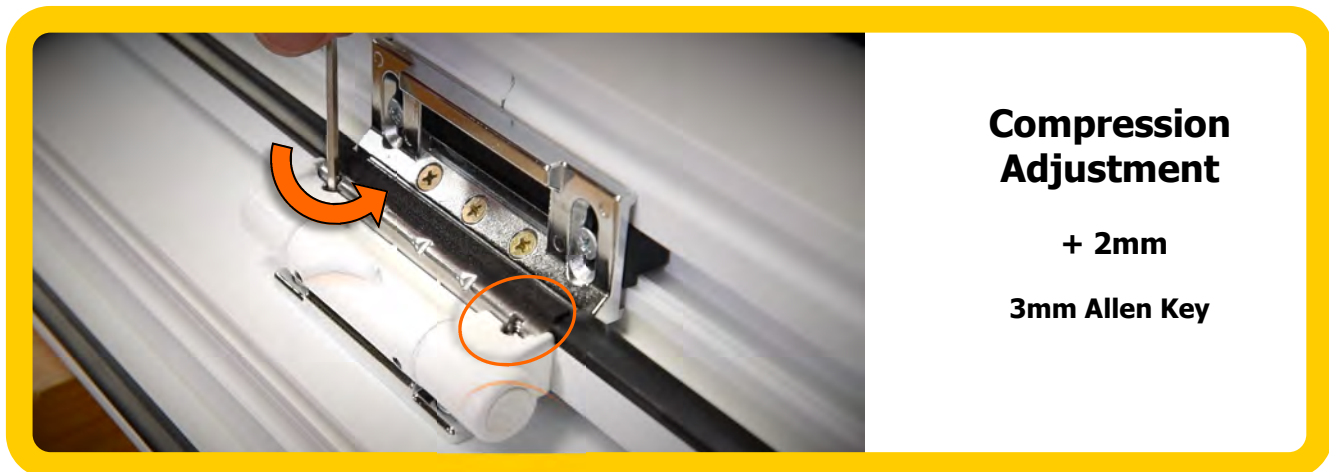

Open the Door to expose the Compression Adjustment Grub Screws
Rotate the Grub Screws Anti-Clockwise to increase compression using a 3mm Allen Key
Note both Grub Screws must be rotated by an equal amount to ensure even adjustment